

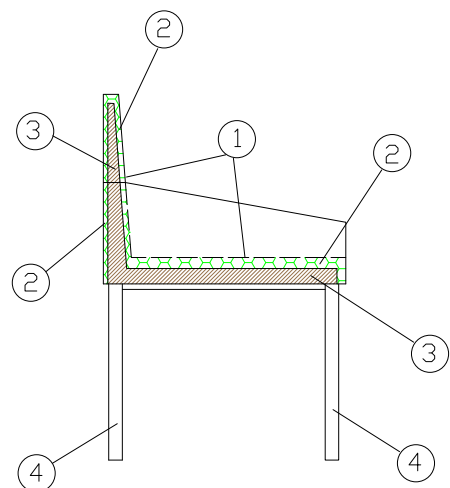

## MATERIALI:

- 1 - fibra di dacron® 100 gr;
- 2 - poliuretano espanso indeformabile di diverse densità;
- 3 - telaio in multistrato di legno;
- 4 - gambe in metallo cromato/  
base girevole B 01-B 03-S 01-S 04:  
base in inox lucido e colonna in metallo cromato/  
base girevole B 02-B 07-B 09 in metallo cromato.



## KELLY COLLECTION:

### Small

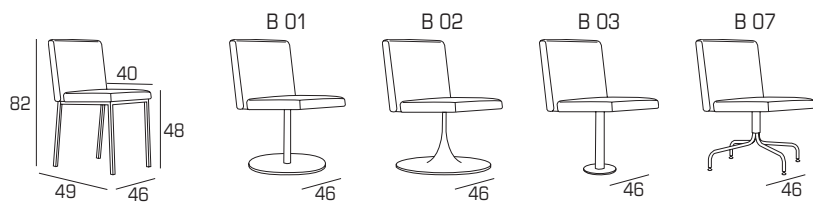

### Large

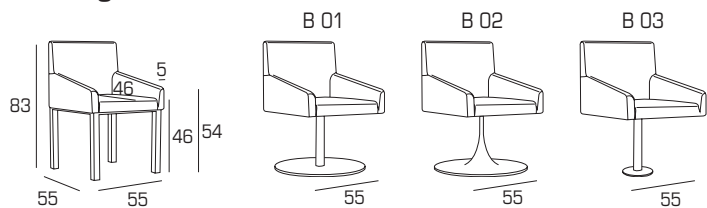

## Maxi

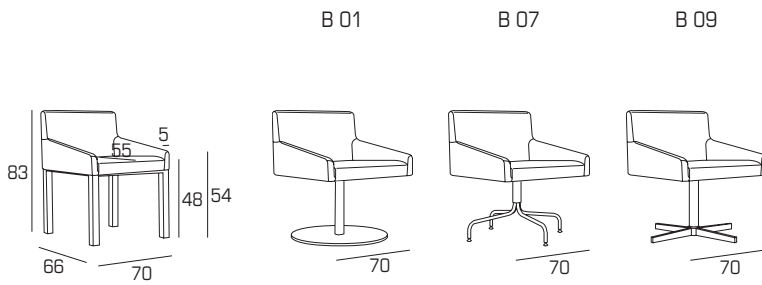

## Stool

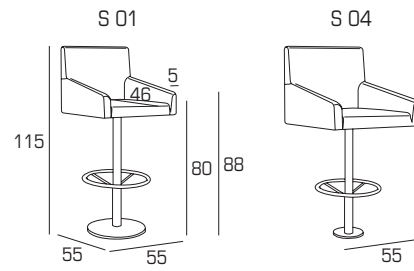

## GAMBE E BASI:

### Small



### Large



### Maxi

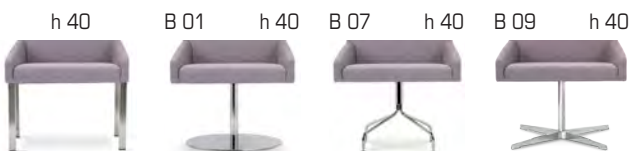

### Stool

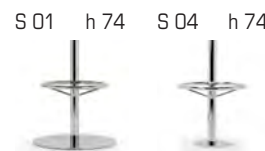

## FINITURE METALLO GAMBE/BASI:

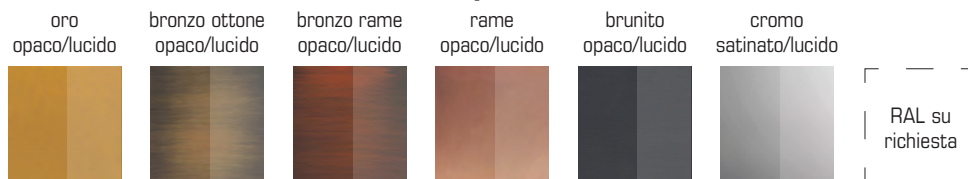

## INFORMAZIONI TECNICHE:

Sfoderabile: NO	kg	m <sup>3</sup>	mts		kg	m <sup>3</sup>	mts
KELLY SMALL	09	0.18	1.00	KELLY LARGE B 03	18	0.25	1.60
KELLY SMALL B 01	19	0.18	1.00	KELLY MAXI	20	0.38	1.80
KELLY SMALL B 02	13	0.18	1.00	KELLY MAXI B 01	35	0.38	1.80
KELLY SMALL B 03	14	0.18	1.00	KELLY MAXI B 07	18	0.38	1.80
KELLY SMALL B 07	12	0.18	1.00	KELLY MAXI B 09	18	0.38	1.80
KELLY LARGE	15	0.25	1.60	KELLY STOOL S 01	26	0.35	1.60
KELLY LARGE B 01	25	0.25	1.60	KELLY STOOL S 04	20	0.35	1.60
KELLY LARGE B 02	16	0.25	1.60				